

# NOTICE DE MONTAGE ACCESSOIRES FLIP - FLIP ACCESSORIES ASSEMBLY INSTRUCTIONS

## MONTAGE-ANLEITUNG FLIP ZUBEHOER - MONTAGE HANDLEIDING ACCESSOIRES FLIP

Avant assemblage, lire attentivement, en complément du présent document, la « notice de montage, d'utilisation et d'entretien », réf. NMU-FR-06-01, jointe.

Es ist überaus wichtig, dieser Anleitung sowie den jeweiligen Hinweisen, « Plänen und Benutzungs- und Wartungsanleitung » ref. NMU-DE-06-01, genau zu folgen und zu beachten.

Before assembling, added to this document, please read carefully the « Using and maintenance instructions » document ref. NMU-GB-06-01.

Lees voordat u met de montage begint aandachtig het bijgevoegde document « montage-, gebruiks- en onderhoudshandleiding » ref NMU-NL-06-01.

### 1 Arrêteur Central / Middle stop / Mitten Anschlag / Verdeelschot

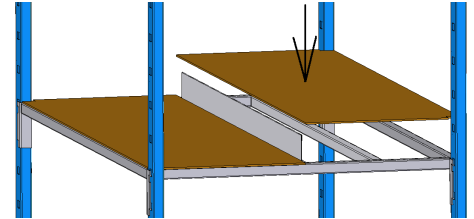
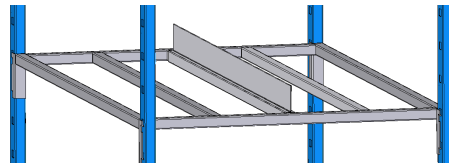
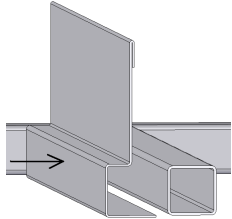

### 2 Rebord de tablette / shelf lip / Anschlagkante / Eindschot

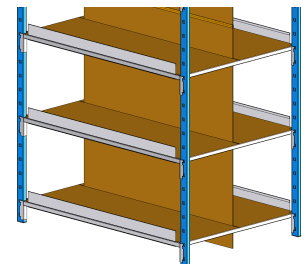
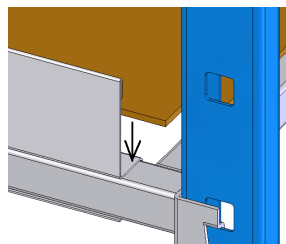
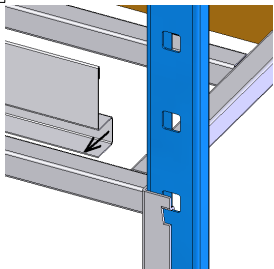

### 3 Arrêteurs de côté / Side stops / Seiten Anschläge / Zij-stop

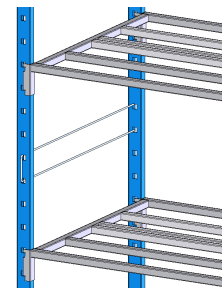
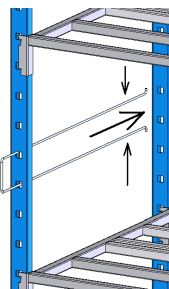
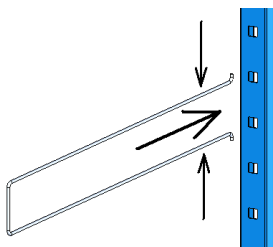

### 4 Plinthe / Plinth / Fussleiste / Plint

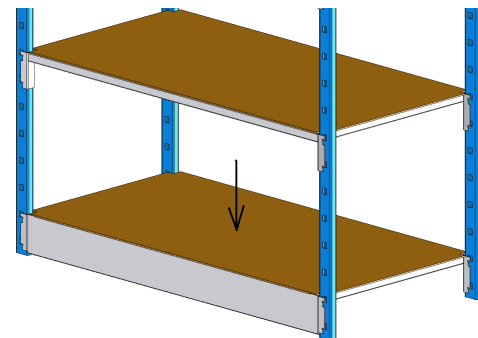
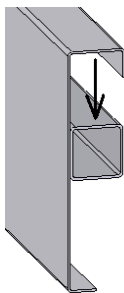

### 5 Barre Portemanteau sur tablette standard / Hanging rail to insert into a standard tubular shelf / Kleiderstange zum Einsetzen in einen standard Gitterboden / Kledingbuis op een standaard legbord

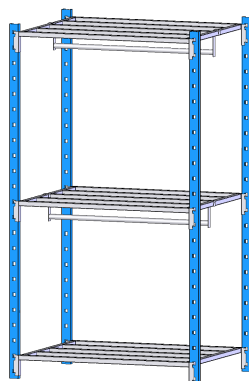
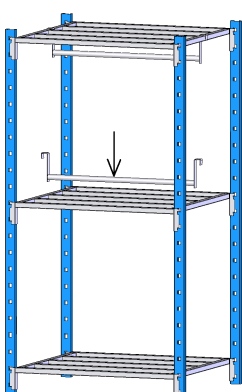

### 6 Tablette porte-manteau / Support clothes shelf / Kleiderträger Gitterboden / Legbord kledinghangbuis

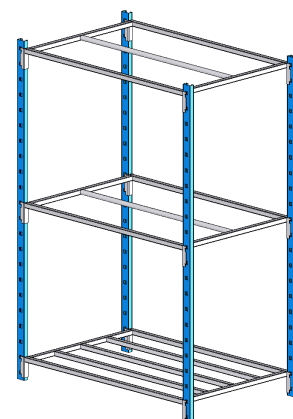

# NOTICE DE MONTAGE ACCESSOIRES FLIP - FLIP ACCESSORIES ASSEMBLY INSTRUCTIONS MONTAGE-ANLEITUNG FLIP ZUBEHOER - MONTAGE HANDLEIDING ACCESSOIRES FLIP

Avant assemblage, lire attentivement, en complément du présent document, la « notice de montage, d'utilisation et d'entretien », réf. NMU-FR-06-01, jointe.

Es ist überaus wichtig, dieser Anleitung sowie den jeweiligen Hinweisen, « Plänen und Benutzungs- und Wartungsanleitungen » ref. NMU-DE-06-01.

Before assembling, added to this document, please read carefully the « Using and maintenance instructions » document ref. NMU-GB-06-01.

Lees voordat u met de montage begint aandachtig het bijgevoegde document « montage-, gebruiks- en onderhoudshandleiding » ref. NMU-NL-06-01

- 1 Séparation coulissante FLICLASS / Sliding dividers FLICLASS / Verschiebbare Fachteiler FLICLASS / verschuifbare verdelers FLICLASS

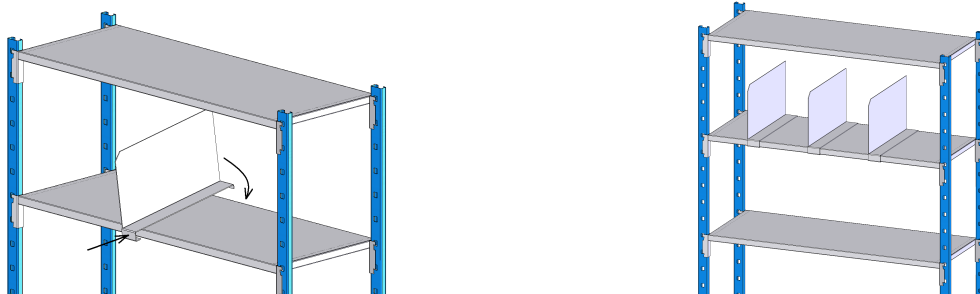

- 2 Séparation aggro / tôle / Steel or chipboard shelf divider / Spanplatte od. Stahlblech Fachteiler / houten of stalen tussenwanden

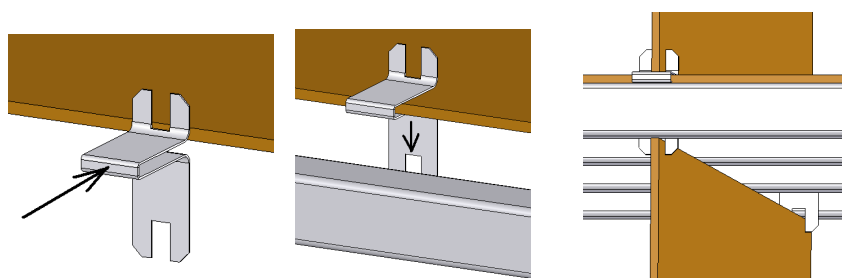
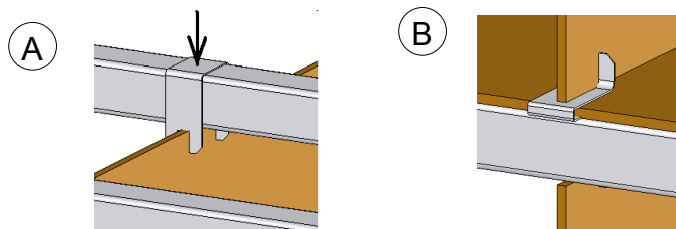
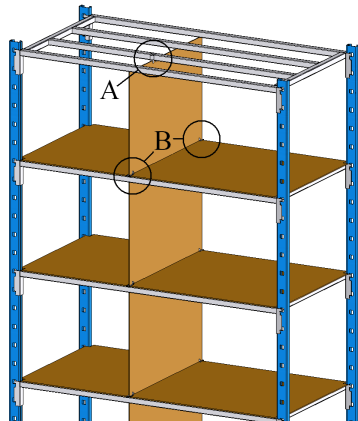

- 3 Vêrin / jack / Schraubenwinde / schroefpoot

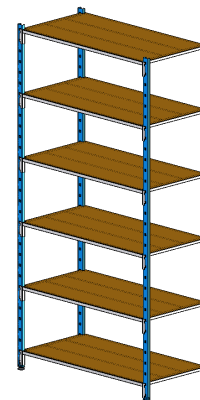
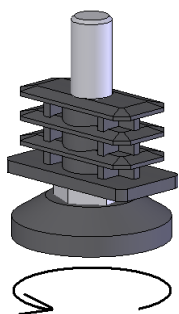

Mettre au minimum / Put at least /  
mindestens zu stellen / zo laag  
mogelijk zetten

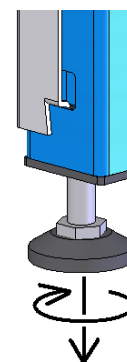
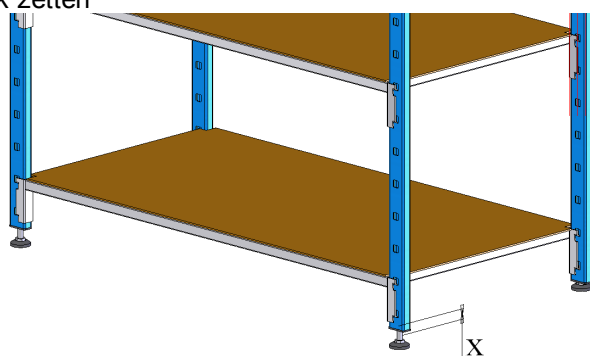

X = 20 mm maximum

Max. 250 kg par poteau / Max. 250 kg per upright / Max. 250 kg pro Ständer / max. 250kg per staander